

# DESIGNING OUR CITY



St. Paul's Co-educational College  
Zhuyuetang Exhibition Gallery



# **DESIGNING OUR CITY**

**An Exhibition on Alumni Design Work**

St. Paul's Co-educational College  
Zhuyuetang Exhibition Gallery  
October 2015

	<b>DESIGNING OUR CITY</b>
Dr. Anissa Chan Dr. Rocco Yim	Foreword Preface
	<b>Places to Live</b>
Andre Fu	The Upper House, Pacific Place
Ada Fung	Yau Lai Estate Phase 5
Andy Lam	56 Plantation Road, The Peak
Andrew Lee SS Yim	The Scissor Staircase 35-37 Mount Kellett Road, The Peak
	<b>Places to Learn</b>
Andrew Lee Douglas Lee	Yasumoto International Academic Park & Wu Ho Man Yuen Building
	<b>Places to Work</b>
Winnie Ho Kenneth Lui Caroline Ma	Public Health Laboratory Centre The Landmark HKBC x Media
	<b>Places to Share</b>
TY Lau Edward Leung Jim Tong William Tseng Timothy Yuen	New Columbarium, Diamond Hill Revitalization Project at Mallory Street / Burrows Street Visual Arts Centre, Hong Kong Museum of Art Tung Wah Coffin Home Historical Restoration Lok Fu Shopping Centre Phase 2
	<b>Places in the City</b>
Bryant Lu Suenn Ho David Lung Ken Wai Rocco Yim	Pak Tsz Lane Park An Architectural Study of The Kowloon Walled City The Search for Vernacular Architecture of Asia Seeking Equilibrium Reconnecting Cultures
Ms. Winnie Ho	Epilogue Exhibition Participants & Contributors

## FOREWORD

陳黃麗娟博士

Dr. Anissa Chan

Principal

St. Paul's Co-educational  
College

St. Paulians of the present day could not imagine what the school was like a hundred years ago in a rented apartment on Caine Road where students sat in circles for classes in improvised classrooms.

Notwithstanding a humble start, over the past hundred years our School has nurtured and witnessed a wealth of talents in our alumni spanning the political, legal, cultural, educational, architectural and social arenas. Their contributions to the society are remarkable and highly recognised.

The Exhibition Gallery, an integral part of the Heritage and Development Trail, is established just in time as one of the Centenary endeavours to exemplify the contributions of our alumni to the society in their many areas of expertise. It will display outstanding and award-winning projects of our alumni and present students on a regular basis. Inaugurating the Gallery is an exhibition on Architecture and Interior Design, "Designing Our City", by virtue of their professions as designers and builders of the city of Hong Kong.

The establishment of the Exhibition Gallery and its first exhibition owe much to the effort and input of the Exhibition and Gallery Taskforces and the contribution of the alumni whose works are shown in this inaugural exhibition. To them, I extend my heartiest gratitude.

We all look forward to be stimulated and inspired.

## PREFACE

嚴迅奇博士

Dr. Rocco Yim

Chairman  
Campus Improvement  
Committee

'Designing Our City' brings together a selection of award-winning projects over the past decades by our alumni in architecture and interior design.

Design is a conscious act and an artistic endeavor. But design is actually more than an art, and it should be judged not just by how well it looks, but also by how well it works, and how well it makes us feel.

In the realms of interior and architectural design, the ultimate objective of the art is to improve our lives, both physically and spiritually.

Good design for the residence would create an environment that is comforting and refreshing, through the provision of appropriately scaled spaces, optimum lighting and ventilation, sensual materials and soothing colours.

Good design for places of learning and work would provide an environment that is efficient and interactive, allowing occupants, be they students, teachers or executives, to focus their minds in certain settings, and to communicate effectively with one-another in others.

Good design for public functions would not only deliver state-of-the-art facilities for those functions, but would create an imagery of the building symbolic of those functions, and provide spaces that could raise people's spirits and nurture their mood before they attend the concert, visit the exhibition, or join the congregation.

Good design in urban planning would result in meaningful public spaces, like parks, plazas and streets, well integrated with the neighborhoods and conducive to the vitality and well-being of the populace.

And good design for all things would always be mindful of the need to conserve our resources, through the reduction of waste, the efficient use of energy, or the preservation / re-use of our heritage structures.

Throughout the years, alumni of St. Paul's in the field of interior design and architecture have delivered good design, fulfilling the above and more, in a diversity of building types and settings. Collectively they have contributed to making our city a better place.

This exhibition bears testimony to their efforts and their service to the community.



傅厚民

Andre Fu 1992

BArch  
University of Cambridge

Founder  
AFSO

## 太古廣場奕居

### The Upper House, Pacific Place

Best Design Le Miami Awards

2014 Top Hotel in Asia & 2013 Top 25 Hotels Worldwide

Tripadvisor's Traveller's Choice Award

2013 Gold List & 2011 Hot List Condé Nast Traveller USA

2012 Travel Top 50 Monocle

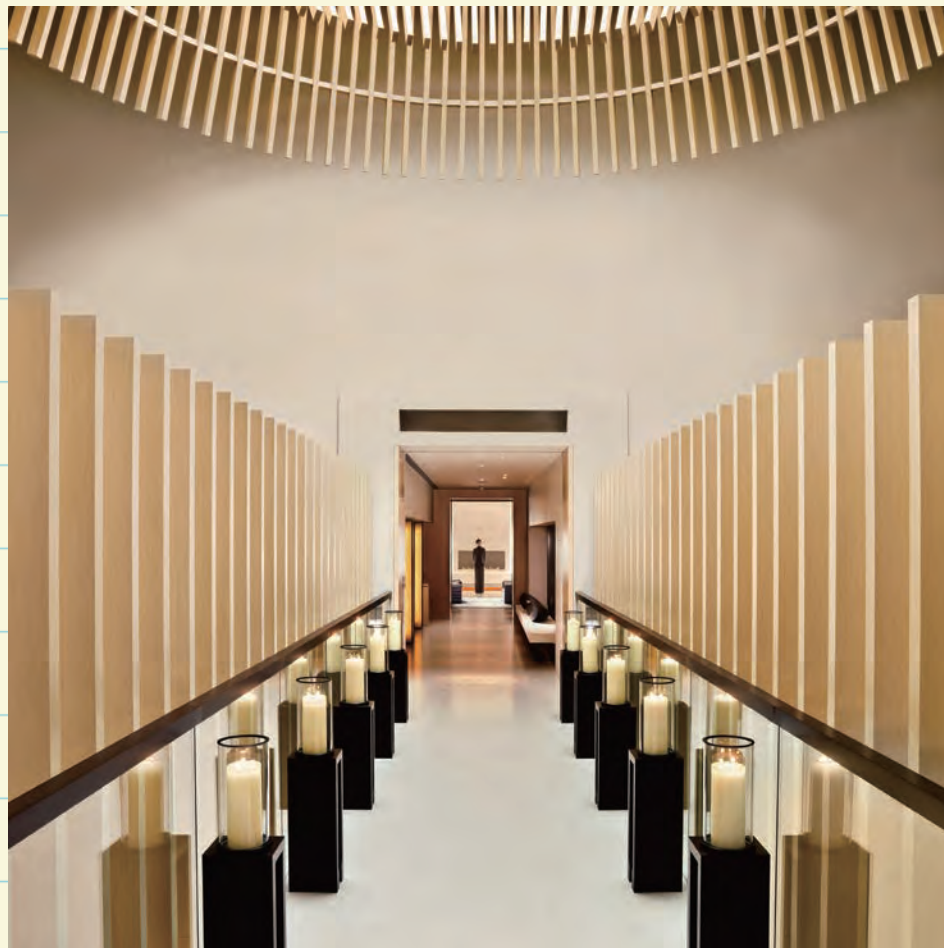

Natural materials, original sculpture installations and seamlessly proportioned spaces are integrated to create a sophisticated and modern "Asian influenced" residence. "With an intention to create a small intimate hotel reminiscent of a private residence, I have purposely conjured a sense of tranquility throughout the design and ambience of the hotel," says Andre Fu. The result is a sophisticated modern-oriental residence, designed with respect to balanced geometry and symmetry, providing all the comforts of a stately home. The palette is restrained, with the use of bamboo, lacquered panels to create an oriental sensitivity, yet the flavour of the scheme, when viewed in its entirety, remains international.

*Andre Fu was the Architect  
of the project*





馮宜萱

Ada Fung 1974

BA (AS) BArch  
University of Hong Kong  
BArch (Dist.)  
University of Hong Kong

Deputy Director  
Housing Department  
HKSAR

## 油麗邨第五期

### Yau Lai Estate Phase 5

2014 Grand Award for Residential Buildings Quality Building Award  
2014 Nomination Award for High Rise Residential Category  
Cross-strait Architectural Design Awards  
2013 Winner of the Residential Architecture Multiple Housing Category  
FuturArc Green Leadership Award  
2013 Award in Construction / Engineering Category  
Hong Kong Institute of Project Management Award  
2013 High Commendation in Construction / Engineering Category  
Asia Pacific Federation of Project Management Award



The project is located at Yau Tong, Kowloon, adjoining Eastern Harbour Crossing Approach Road and Yau Tong Road. Our planning and design theme is to create a sustainable community for a green and healthy living habitat for around 2,000 families. We adopted a holistic approach to overcome the site constraints, optimizing development potential, enhancing the built environment and creating a sense of neighbourhood. We pioneered to adopt microclimate studies to enhance the wind environment, natural ventilation, daylight, and mitigate solar heat gain, whilst mitigating severe noise impact due to heavy traffic. As such, we provided people-oriented quality housing in a garden setting within this congested site, comprising two 39-storey public rental housing residential blocks, a non-domestic block providing 169 car parking spaces, welfare facilities including a Day Care Centre for the Elderly, an Early Training and Education Centre, and a Kindergarten.

*Ada Fung was  
Deputy Director of  
Housing Department*



## 林兆光

Andy Lam 1981

BA BArch (Dist)  
University of Manchester

Chairman & CEO  
Baron Group

## 山頂種植道 56 號

56 Plantation Road, The Peak

2001 Certificate of Merit Award

HKIA Annual Award (Residential Building Category)



The 4,306 sq m site is flanked by Plantation Road to its south and Severn Road to its north. It is perched on a cliff-edge overlooking Victoria Harbour and much of Hong Kong Island.

The proposal avoided the costly and time-consuming process for town planning lease modifications whilst complying with the restriction by proposing six triplexes spread over two blocks sharing two common entrances.

Each triplex is approximately 4,500 sq ft, built to the maximum height limit around a central sky-lit atrium. Each triplex is designed in split-levels, staggering each floor by a half storey front and back.

The triplexes are pure geometric forms juxtaposed, creating planes and volumes that are clearly defined. Cladding materials are contemporary; modular aluminum panels in white and grey, polished and flamed beige granite with an expanse of high performance glass panels.

*Andy Lam was the Founder,  
Shareholder and Director  
of LCL Architects Limited*



李景勳

Andrew Lee 1950

BA(AS) BArch  
University of Hong Kong  
BArch  
University of Melbourne

Chairman  
Andrew Lee King Fun &  
Associates Architects  
Limited

## 鉸剪梯 The Scissor Staircase

Selected for Hong Kong's Debut at  
Venice Biennale 2006 Architecture International Exhibition  
In Recognition of Excellence in Architecture  
HKIA Award for Members Work outside Hong Kong

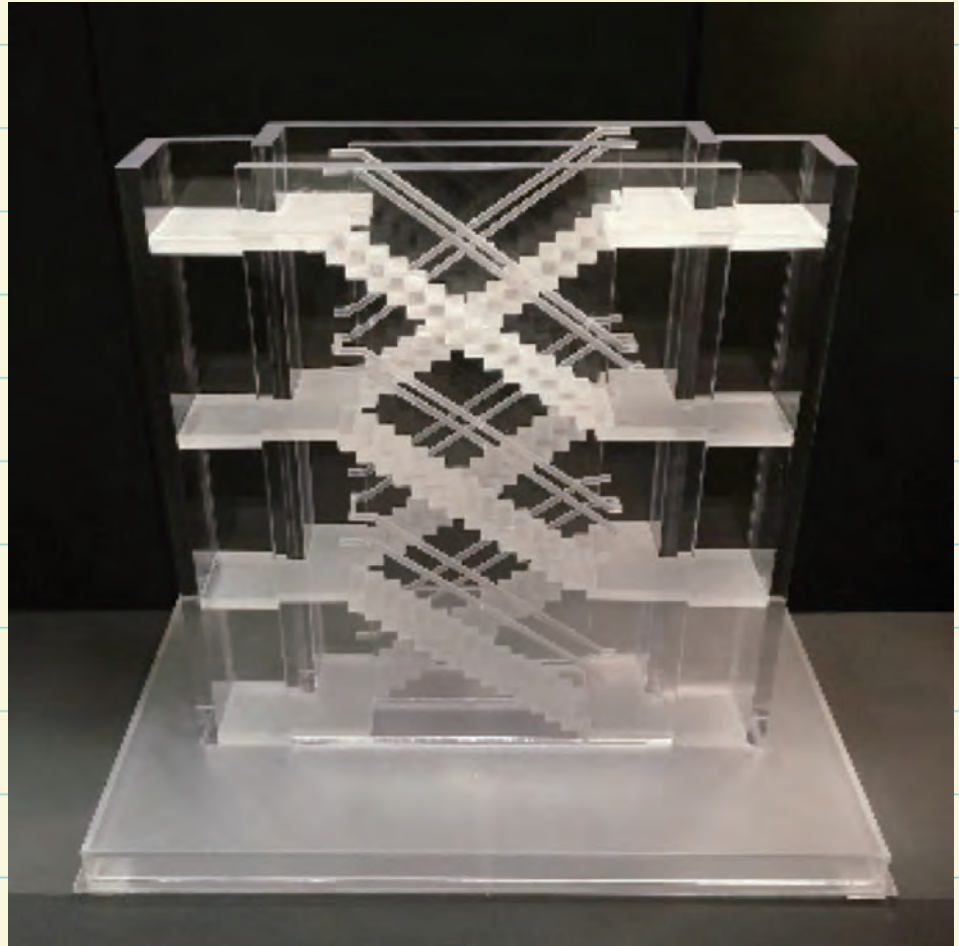

The adaption of scissors staircase leads to the progressive articulation of the building plan complying with local socio-economic constraints in Hong Kong. Scissors staircase lives in the core of almost every building in the contemporary city and its formulated interventions still resonance in the architecture of our present time. Though we seldom walk from one storey to another by intervention, this syndrome of rare encounter of scissors staircase bring us to a psychological displacement, where the context is misplaced and we often are disoriented by journey.



## 山頂加列山道 35-37 號

35-37 Mount Kellett Road, the Peak

2010 Certificate of Merit HKIA Annual Award

嚴迅思

S S Yim 1977

BA(AS) BArch

University of Hong Kong

Director

Handi Architects Limited



The Architect was faced with the task to capitalise the full potential of the beautiful sloping site at the Peak which was occupied by a single 'Taipan' house, both in terms of development area and its magnificent 270 degree view.

The Architect created a crescent internal road to reach 4 independent houses sitting on terraces at different levels. Each house is oriented strategically to the unique view while providing self-screening to achieve maximum privacy of the garden and pools.

The pitched roofs of the houses provide harmonious roofscape within the development and echo the silhouette of the hills.

With the spatial design of all houses based on a naturally lit double storey stairwell, each house and gardens has its individuality in design. The external finishes of each house are based on a common palette of stones and terracotta tiles, but is charged with different highlights and textures to give its unique identity.

*S S Yim was  
Project Director*



李景勳

Andrew Lee 1950



李嘉胤

Douglas Lee 1977

BArch  
University of Melbourne

Executive Director  
Andrew Lee King Fun &  
Associates Architects  
Limited

## 香港中文大學康本國際學術園及伍何曼原樓 Yasumoto International Academic Park & Wu Ho Man Yuen Building, Chinese University of Hong Kong

2015 Silver Medal HKIA Annual Awards  
Cross-Strait Architectural Design Awards (Architectural for Social Innovation)  
2013 Gold Award for Urban Regeneration, MIPIM Asia Award  
2012 Special Architectural Award (Urban Design), HKIA Annual Awards



The development of Yasumoto International Academic Park is an education facility in Chinese University of Hong Kong, comprising two towers (10 and 6-storey respectively) on a 4 storey podium, housing lecture theatres, classrooms and research library facilities for approximately 4,000 students. It also has accommodating teaching facilities such as offices, amenities, data centre for staff and bookstore and café for public.

*Andrew Lee and Douglas  
Lee were Project Directors  
in associate with  
Moore Ruble Yudell  
Architects & Planners*



## 公共衛生檢測中心

### Public Health Laboratory Centre

2003 Certificate of Merit HKIA Annual Awards

何永賢

Winnie Ho 1981

BA(AS) BArch  
University of Hong Kong

Deputy Head  
Energizing Kowloon East  
Office of  
Development Bureau



The Public Health Laboratory Centre provides high quality laboratory facilities to enable the Department of Health (DH) of the Hong Kong SAR Government to carry out its public health function effectively on surveillance, control of infectious disease, and statutory control of food and drugs.

The Pathology Service of DH plays a key role in supporting the surveillance, investigation, prevention and control of infectious diseases. Provision of high quality public health laboratories is necessary to enable DH to discharge its statutory responsibility of safeguarding the health of the community against the threat of infectious diseases.

*Winnie Ho was the Design  
and Project Architect under  
Architectural Services  
Department*



呂志堅

Kenneth Lui 1969

BArch  
University of Arizona

Director  
P&T  
Architects and Engineers

## 置地廣場

### The Landmark

1982 Silver Medal Award

Hong Kong Institute of Architects Annual Awards



The Landmark occupies nearly a full city block in the heart of Central District. With twin 44-storey office towers, the development features extensive retail and public areas, extending four levels above ground and linked by bridges to neighbouring developments.

The column-free office floors have deeply recessed windows on all sides which reduce cooling loads.

Tower columns extend through the lower public areas, forming the edge of a large skylit square atrium. Its shape is accented by balconies and terraces and animated by a fountain, trees and public art, making the landmark a popular urban amenity and meeting place and the centre of Central.

*Kenneth Lui was  
Project Director*



馬家柔

Caroline Ma 1985

BArch  
Cornell University

Principal  
Jason Caroline Design  
Limited

## 媒體無限

### HKBC x Media

2014 Outstanding Greater China Design Awards

2014 Asia Pacific Interior Design Award



HKBC Media has established their headquarters in Chai Wan, Hong Kong. The group promotes creative sound products and online media broadcast to distribute influential voices for the new generation. Our task is to set the creative mood and craft a suitable corporate image for the group.

The space is divided into four zones, centralized by the Creative zone which is surrounded by the Recreation, Production & Management zones. The library in the centre is the heart of the office space. Against a sophisticated yet cutting-edge backdrop, it can be further expanded and spatially connected with the main studio, through a 2.5m x 5.7m TV swing door. Recreation zone behind the Library promotes healthy and playful environment for the employees of this 24-hour operating office.

We explored how different spatial experiences and better working environment can stimulate creativity and productivity in a working environment. The project also investigate spatial relationship between different functions and dialogues between different zones.

*Caroline Ma was Design  
Director of the project*





劉達楹

Lau Tat Ying 1967

BArch  
University of Oregon

Architectural Services  
Department HKSAR

## 鑽石山新靈灰安置所

### New Columbarium, Diamond Hill

2014 Space Design Merit Design for Well Being Awards

2014 Venice Biennale Selected Exhibit in the Hong Kong Pavilion

2012 Certificate of Merit Skyrise Greenery Awards (Government Projects)

2010 Certificate of Merit HKIA Annual Awards



Physical well being and psychological well being for the people are the prime concerns of this project.

The unique design of this building takes care of the effective people flow and improve natural ventilation.

Shaped like a hill, the building accommodates the Chinese tradition of Bye Saan --- going up the mountain to pay respect to the ancestors at festivals. With its roof being flights of landscaped steps, it enables people access to the niches of their ancestors on the different floors in a nature like environment.

Located in the urban setting, it is important to address the psychological impacts to the neighborhood. The niches walls are arranged perpendicular to the main road and the ground floor is a public sitting out area, there is no niche visible from the street.

Here, the image of the columbarium as a scary ash-storing structure has been transformed into a pleasant park enjoyable by the public all year round.

*Lau Tat Ying was  
the Design Team Leader  
of the project*



梁以華

Edward Leung 1981

BArch (Dist.)

University of Manchester

MSc

University of Hong Kong

Associate Director

Aedas

## 茂羅街保育項目

### Revitalization Project at Mallory Street / Burrows Street

2014 Medal of the Year HKIA Annual Awards

2014 Renovation and Revitalization Merits Award Quality Building Award

2014 Sliver Award Hong Kong Institute of Planners Annual Awards

2014 Silver Award in CCRRP Cross-Strait Architectural Design Awards

2014 Recognition of Excellence MIPIM Asia Award

2014 A&D Architectural: Heritage Trophy Award

2014 Special Project Award Hong Kong Institute of Engineers

2014 Merit Recognition Design for Asia Award Annual Award



This project is an urban conservation and adaptive re-use of a rare and intact ensemble of 10 shophouse buildings from 1910s. The project brief asked for three almost impossible concurrent tasks: (a) Provision of a 300 sm Public Open Space within a tight urban site as required by Town Planning, (2) Preservation of the historic shophouses buildings on site, and (3) Revitalizing it into an Art and Cultural Centre as resulted from Public Consultation. This design celebrates the value of Pre-war Shophouse as a testimony of historical development of architecture of Hong Kong. Through the revitalization of this rare and intact historic ensemble to suit modern public use, the wisdom of spaces and materials of early urban architecture is interpreted and presented to the public, and the practical potential of re-using and improving urban historic fabric is demonstrated to the society.

*Edward Leung  
was the Design Architect  
of the project*



## 香港視覺藝術中心

Visual Arts Centre,  
Hong Kong Museum of Art, Kennedy Road

1992 Certificate of Merit HKIA Annual Award

### 唐景彬

Jim Tong 1965

BA(AS) BArch  
University of Hong Kong

Executive Director  
(Retired)  
Wong Tung & Partners  
Limited



The Visual Arts Centre makes available studio and exhibition spaces to sculpture, ceramic and print making artists and was converted from an original building in Victoria Barracks, now Hong Kong Park. Originally officers' quarters, the Cassels building was built in the 1900's and forms part of the Hong Kong architectural heritage. Comprising four graceful, stepping and disjointed 3-storey blocks it was domestic in scale with little inter-connection. The studios and exhibition spaces were accommodated in the existing building to suit the building volume. Service spaces and larger spaces including a lecture theatre were housed in a new extension which allows the facades and profile of the existing building to remain entirely intact. A sky-lit circulation spine encloses a system of bridges, ramps, voids and stairs making the intricate circulation, with all levels accessible to wheel chair traffic, comprehensible, and bridges the circulation and the services between the existing building and new extension. The Visual Arts Centre was officially opened in May 1992.

*Jim Tong was the Design  
Director of the project*



岑延威

William Tseng 1977

BA(AS) BArch (Dist.)  
University of Hong Kong

Director  
Urbanage International  
Limited

## 東華義莊復修

### Tung Wah Coffin Home Historical Restoration

2005 Certificate of Merit

UNESCO Asia-Pacific Heritage Awards (Culture Heritage Conservation)

2004 Award of Honours Hong Kong Heritage Award



The TWGHs Coffin Home has over a hundred years of history dating back to the 1890s. It provided temporarily coffin storage for deceased overseas Chinese workers enroute from aboard to their home town. The need for the service has greatly declined and the compound has been turned into a historic heritage. The TWGHs has decided to restore the estate in order to preserve the history and its tradition.

The estate of the Coffin Home occupies a compound of over 6000 sqm in the scenic Sandy Bay Cemetery. There are 7 clusters of buildings. They were constructed over a period of 80 years. Each of the building clusters carries a distinct architectural character, ranging from traditional vernacular village style to a mix of colonial and Chinese style. A detailed study based on historic records and collections from the TWGHs Museum was conducted before the carrying out of the restoration work. The compound has been restored to reflect different periods of operation in context with their respective history.

*William Tseng was  
the Project Director  
of the restoration work*

The project was recognized by the HKSAR Government with the Top Award of Honours in the 2004 Hong Kong Heritage Award. It was further honoured in the 2005 UNESCO Asia-Pacific Heritage Awards for Cultural heritage Conservation.



## 樂富中心第二期

### Lok Fu Shopping Centre Phase 2

1991 Certificate of Merit HKIA Annual Award

1992 ARCASIA Award for Architecture

袁棣恩

Timothy Yuen 1980

BFA BArch

Rhode Island

School of Design

MArch

Harvard University

High Dip

Cheung Kong

Graduate School of Business

MSc

University of Hong Kong

Founder & CEo

iLearners

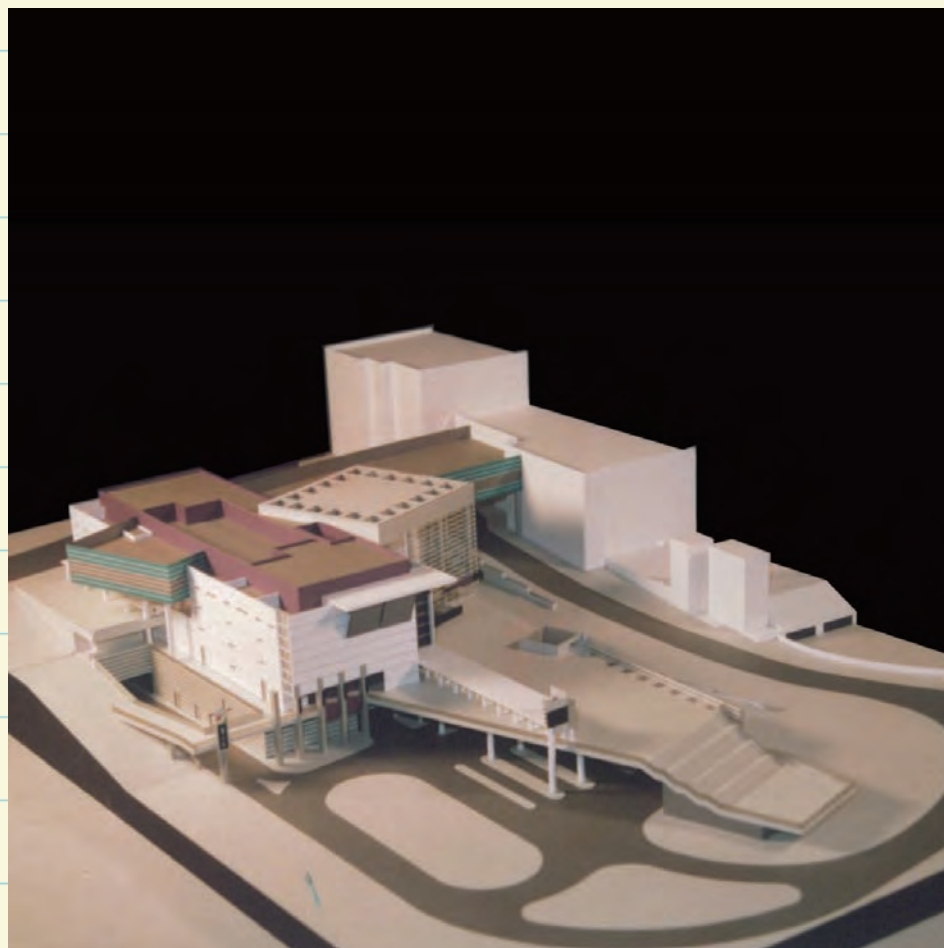

Lok Fu Shopping Centre Phase 2 was to create a physical community / shopping center on top of Lok Fu MTR Station, connecting to existing housing estates and community facilities, while creating a landmark meaningful to residents of Lok Fu.

Architectonic forms are selected to represent its urban context, harbouring among housing blocks, public parks as well as multi-level of transport modes. Formal collisions and spatial intersections resulted from tectonic superimposition created opportunities for interesting yet meaningful spaces within this miniaturised metropolis. Lok Fu Shopping Centre Phase 2 thus attempted to represent Hong Kong's urban complexity in a rational and illustrative manner.

*Timothy Yuen was Project Architect and Rocco Yim was Project Director*



呂慶耀

Bryant Lu 1991

BArch  
Cornell University

Vice Chairman  
Ronald Lu & Partners

## 百子里公園

### Pak Tsz Lane Park

2014 Honorable Mention

International Union of Architects Award “Friendly Space Accessible to All”

2013 Certificate of Merit HKIA Annual Awards

2013 Certificate of Merit for Urban Design

2013 Bronze Award Design for Asia Award

American Institute of Architects Hong Kong Chapter Honors and Awards



A century ago, the Furen Society ( 輔仁文社 ), veiled in the alleyways of Pak Tsz Lane, sowed the seeds to the Xinhai Revolution ( 辛亥革命 ). In 2011, its surrounding site has been revitalized as a courtyard park with conserved trees, old stone wall and a water well, and traced the footprint of historic settlement lot plans. With due respect to the as-found site formation and configuration, the design of Park Tsz Lane Park comprises a feature pavilion, terraced exhibition spaces linked in ramps and a children play area. The park opens at the centenary of and commemorates this place as the breeding ground to the Xinhai Revolution.

Ronald Lu & Partners designed the Park as a humble one with whitish wall plasters, Chinese granite pavers, recycled timber with script inscription, and bronze sculpture, the architectural elements are infused with revolutionary spirit. Visitors and locals both young and old can traverse time through space or rest in this hidden urban oasis.

*Bryant Lu was the Design  
Director of the project*



## An Architectural Study of The Kowloon Walled City - Preliminary Findings

2014 Honorable Mention Urban Land Institute (NW) Photo Essay Contest  
1991-1992 Fulbright Fellowship Research Grant

何巽

Suenn Ho 1980

BArch  
Williams College  
MArch  
Columbia University

Principal  
Resolve Architecture

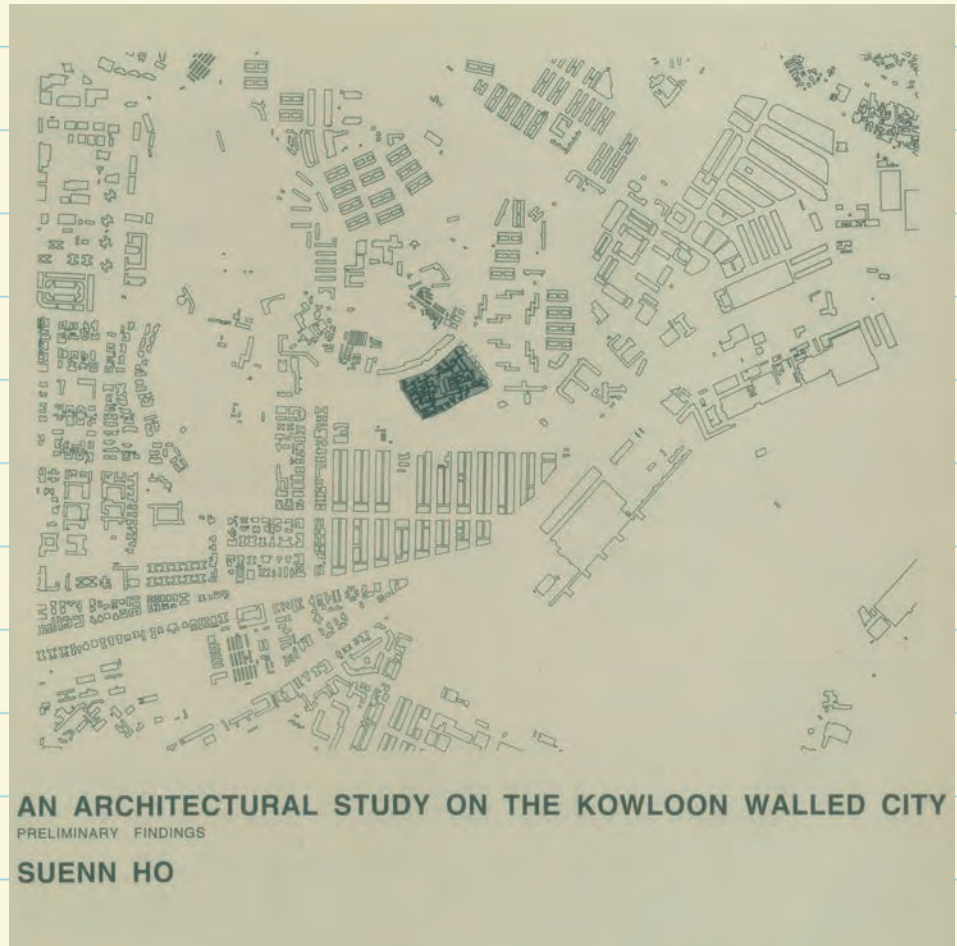

This work represents the preliminary findings from my ten-month Fulbright research grant. The research evaluates the Kowloon Walled City architecturally in order to appreciate this unique housing phenomenon as a hard-to-come-by case study on high density urban housing design. Although the development of this living environment was shaped by a variety of historic, political, social and cultural factors, by focusing on the architectural principles found at the Kowloon Walled City, I hope to offer a unique perspective, one which investigates how the architecture and the community have influenced each other.

The main goal of my investigation is to explore the interrelationship between the Walled City's architecture and its inhabitants and to examine how this interrelationship has surprisingly benefited the sense of community in spite of the Walled City's notorious reputation as a ghetto.

*Suenn Ho was Author and  
Urban Designer  
of the project*



龍炳頤

David Lung 1967

BArch MA MArch  
University of Oregon

Professor  
University of Hong Kong

The Search for Vernacular Architecture of Asia  
Massive Online Open Course  
University of Hong Kong

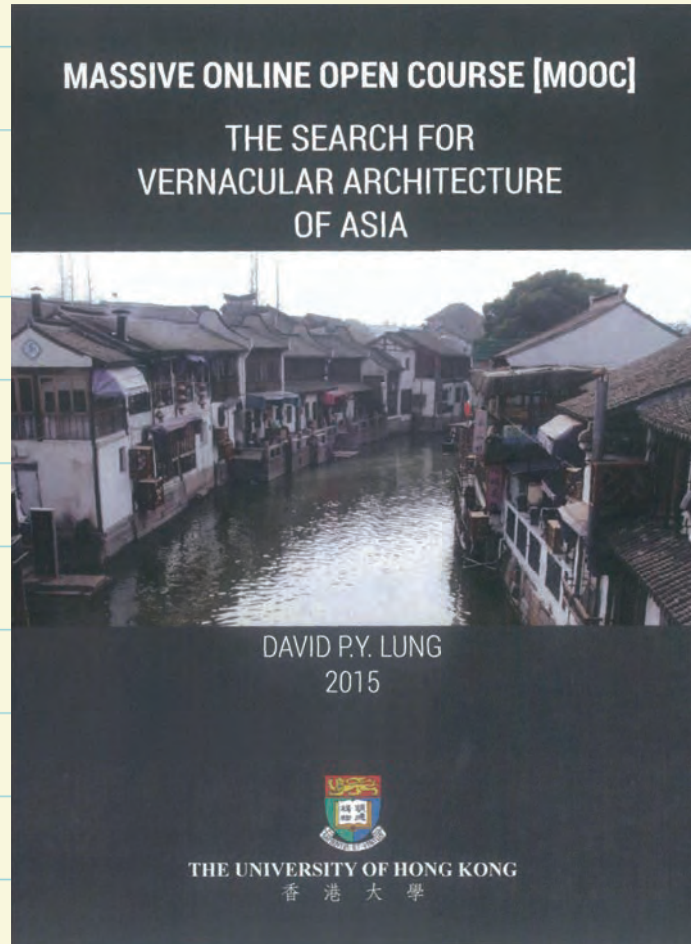

Vernacular architecture includes both buildings and landscape, urban or rural, which are made by ordinary people, based on a shared knowledge that are commonly understood and shared among the people of the same cultural or ethnic root; and more importantly, that knowledge is handed down through generations in the form of traditions; it is a process of transmission of a knowledge from one generation to another.

*David Lung was  
Author of the Course*





## Seeking Equilibrium Architecture of Ken Wai

韋業啟

Ken Wai 1977

Leeds Metropolitan  
University

East London University

Global Board Director  
&  
Design Director  
Aedas

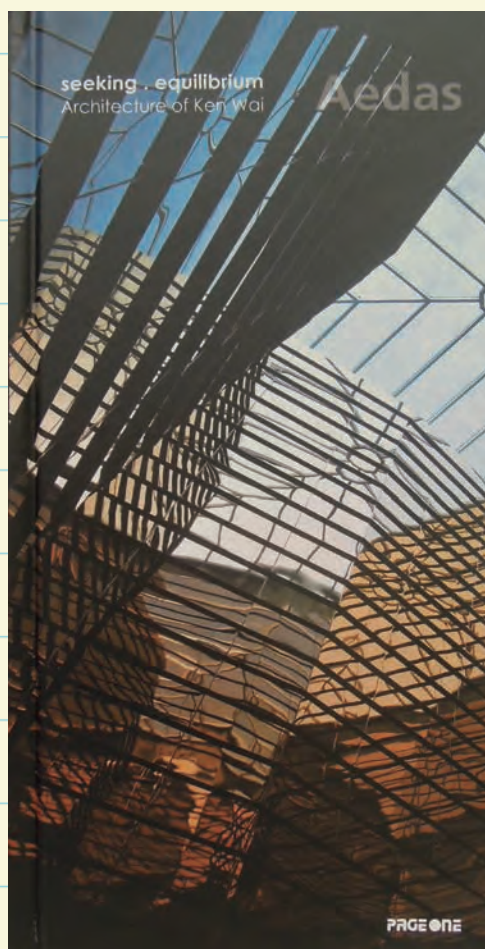

Architectural design can be defined as a continuous search for an equilibrium between sense and sensibility: sense in terms of good judgment based on practical ideas or understanding; and sensibility being good aesthetic judgment. The book begins with a brief description of this sense-and-sensibility design approach. To vividly explain how different requirements are being accommodate to generate an architectural solution that seeks a balance, it is followed by a catalogue of Aedas projects designed by Ken Wai based on these principles, which covers a series of building types including office, mixed-use, hospitality, residential, infrastructure, institution, interiors and civic architecture. Each project is explained through drawings, plans, photos and detailed descriptions in order to present the full picture.



## Reconnecting Cultures The Architecture of Rocco Design

嚴迅奇

Rocco Yim 1969

BS(AS) BArch  
DSocSc(Hon)

University of Hong Kong

Co-founder & Principal  
Rocco Design Architects  
Limited

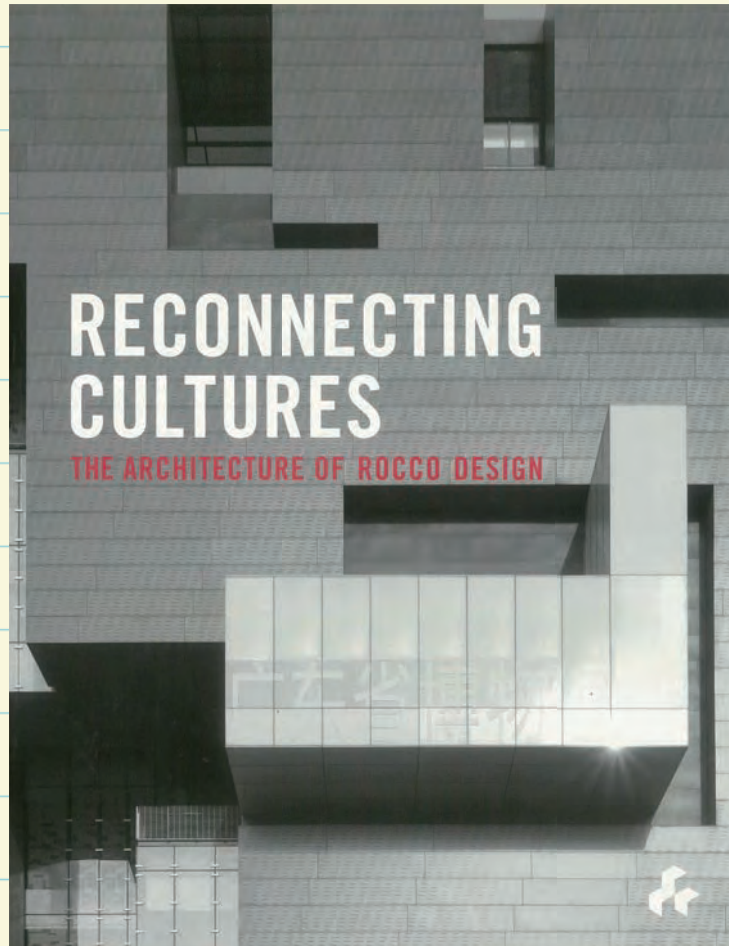

A Monograph of Projects by Rocco Design Architects

## EPILOGUE

**何永賢女士**

Ms. Winnie Ho

Chairlady

Taskforce on Exhibition

**黎詠儀女士**

Ms. Winnie Lai

Co-ordinator

**龍炳頤教授**

Prof. David Lung

Member

**岑延威先生**

Mr. William Tseng

Member

**嚴迅奇博士**

Dr. Rocco Yim

Member

**袁棣恩先生**

Mr. Timothy Yuen

Member



Organising this exhibition allows me to connect to a group of alumni who have a lot of contribution in the field of architecture and design during the past decades. The most senior alumnus graduated in 1950 and the youngest in 1992, spanning across more than 40 years. I hope this exhibition is just a start to bring them together and back to the school to link up with the current students. Apart from organizing the exhibition, the taskforce has also taken this opportunity to allow students to participate in the exhibition preparation process. They had joined our taskforce meetings, had an active dialogue with architects presenting their projects, visited architects' firms and also helped us in the final set up. We greatly treasured this opportunity to work with the students and helped them develop their interest in this area and to pursue their career as architects and designers. I hope this is just the beginning, and more sharing will come.

I would like to express my most sincere thanks to the school for supporting us to organize this exhibition, and also to the teachers who have helped us to coordinate with the students. Finally, my heartfelt thanks to all the taskforce members for their advice and unfailing efforts during the past few months. I hope they have enjoyed this process as much as I do.





**Young aspiring minds who are interested to pursue their career in art, design and architecture.....**



**A beginning to connect across generations..... and more will come**



## 參展舊生 Exhibition Participants

### *Places to Live*

Andre Fu  
Ada Fung  
Andy Lam  
Andrew Lee  
SS Yim

### *Places to Learn*

Andrew Lee and Douglas Lee

### *Places to Work*

Winnie Ho  
Kenneth Lui  
Caroline Ma

### *Places to Share*

TY Lau  
Edward Leung  
Jim Tong  
William Tseng  
Timothy Yuen

### *Places in the City*

Bryant Lu

### *Publications*

Suenn Ho  
David Lung  
Ken Wai  
Rocco Yim

## 參與同學 Exhibition Contributors

### *Exhibition Catalogue Illustration*

Jovian Cheung

### *Exhibition Installation*

Cherry Chan	James Chen
Jovian Cheung	Jasen Ho
Kiki Lam	Edmond Lee
Kelvin Lo	Jocelyn To

### *Docents*

Leigh Chan	Sara Chang
Jovian Cheung	Iris Duong
Beckie Hsu	Adrian Kwan
Adrian Kwong	Kiki Lam
Kelvin Lo	Nicolle Man
Michael Ngan	Hosanna Ser
Lorraine Tang	Alan Tsang
Florence Wong	Portia Wong

## 鳴謝

### Acknowledgement

The following alumni and parents have contributed to Taskforce on Gallery Design and the development of SPCC Heritage and Development Trail

Mr. Andre Fu  
Mr. Jackson Harun  
Ms. Elaine Lau  
Mr. Vincent Lau  
Mr. Gabriel Lee  
Mr. Gregory Leong  
Ms. Jennifer Tsang  
Mr. Hubert Un  
Mr. David Wong  
Mr. Ronald Yang  
Mr. Jeffrey Yue  
Mr. Timothy Yuen (Chairman)  
Mr. & Mrs. Caroline & Jason Yung

And

Mr. Jason Yung of Jason Caroline Design Limited on the design of Zhuyuetang Exhibition Gallery

And

The following teachers have organized student presentation and exhibition volunteers

Ms. Amanda Hsu  
Mr. Richard Kallagher  
Ms. Ivy Leung  
Ms. Jennifer Lo (Vice Principal)  
Ms. Ritta Mok

The University of Hong Kong for use of the teaching video on Vernacular Architecture and Mr. Edwin Wu for the editing of video for SPCC Centenary Exhibition

The Hong Kong Institute of Architects for use of video "Teaching Kit for the Appreciation of Architecture in Secondary School Curriculum"

Energizing Kowloon East Office of Development Bureau for venue and student presentation

Ronald Lu and Partners Limited for venue and student presentation

Urbanage International Limited for student presentation

And

Mr. Victor Chu of Hubert Un Associates Limited for the production of slide presentation

Mr. Yam Ho of iLearners Publishing Limited for the production of exhibition catalogue

St. Paul's Co-educational College  
33 MacDonnell Road, Hong Kong